



ALL HANDS TO THE PUMP

**S-CLEAN hand-washing system:
An innovative hand wash**



Stay clean, stay safe, stay comfortable with the S-Clean system

This new accessory allows you to wash your hands before getting into the cabin and handling expensive electronic tools.

5 reasons to choose the S-Clean system



- ✓ Easy to attach to the tractor cab access bar
- ✓ Helps you keep your driving environment clean
- ✓ Aesthetically integrates into all types of machines
- ✓ Holds 3 litres of water, allowing 5 to 10 washes
- ✓ Patented valve with dual control, to keep clean hands protected

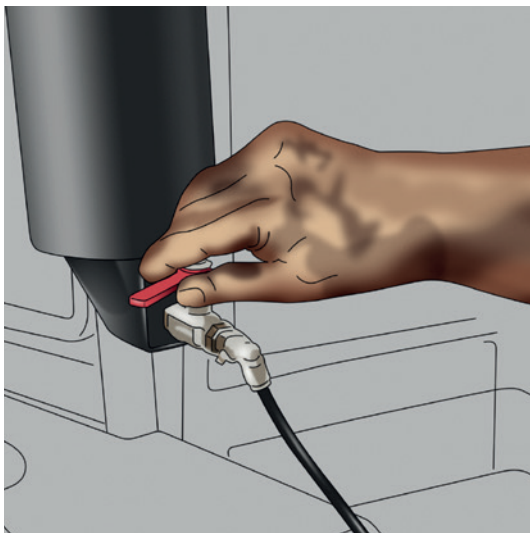

When hands are dirty:
Red valve to run the water

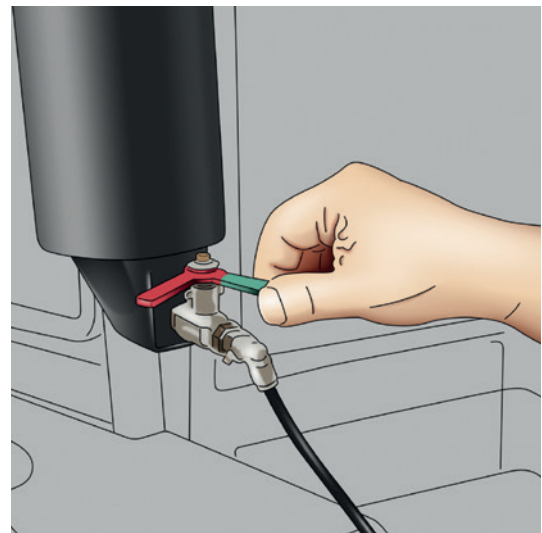

When hands are clean:
Green valve to turn off the water

For more information, please contact your AGCO dealer.

Installation instructions



Material provided in the kit

- A. Container (holds 3 litres) equipped with a tap
- B. Fixing brackets
- C. Bottle holder and half-litre container for soap liquid
- D. Valve handle
- E. Protective spiral sheath
- F. Plastic pipe that can be cut to adapt the length
- G. Required fixings



Tools required

- 2 x 13 wrenches to fix the brackets
- 1 x 7 wrench to screw the valve
- 1 x 5 Allen key to fix the flange on the bottle and the soap dish

Make sure that the S-Clean system:

- Does not interfere with visibility for driving
- Does not hide the signalling devices (flashers) in accordance with the highway code
- Does not interfere with access to the cabin
- Does not flow into electrical systems

Warning:

- The upright of the cabin must not be modified or drilled
- Do not drink the water contained in the S-Clean

Installation of S-Clean is the responsibility of the user. In the event of an incident, AGCO Limited, Syngenta and Solhead cannot be held liable.



1 According to the desired orientation of the valve, choose the fixing points of the bracket.



2 Attach the first bracket onto the container.

- 2 M6x16 bolts
- 2 grower M6 washers



3 Attach the soap dish onto the container.

- 2 M6x16 screws

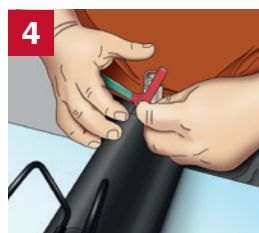

4 Attach the valve.

- 1 M8 washer
- 1 grower M8 washer
- 1 handle
- 1 M4 washer + 1 bolt

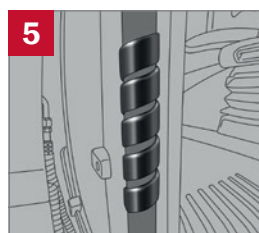

5 Position the spiral sheath on the grab bar.



6 Attach the container with the second bracket on the support and spiral sheath.

- 4 M8x30 bolts
- 8 M8 washers
- 4 M8 nuts

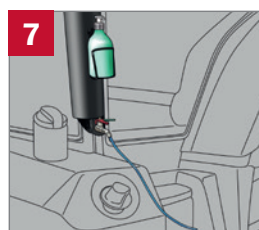

7 Install the pipe onto the valve and cut to the desired length.



The S-Clean system can be mounted on a wide range of machinery to meet your hand washing needs.

DEALERSHIP